

## Best Practices in Setting Up a Media Library

Use your ScreenPlay Pro HD to consolidate your multimedia files for easy access on your TV or across your home network!



Overview	2
Organizing Media Files	2
ROOT Level	2
Using Subfolders	3
Loading Media Files Using a Direct USB Connection	3
Formatting the ScreenPlay Pro HD for Direct Use on a Mac	4
Loading Files Across a Network	5
Accessing Media Files Across the Network	6
Enjoying Your Media Library on the TV	7

## Overview

Your ScreenPlay Pro HD Multimedia Player offers high capacity storage space for your collections of music, video, and photos. If the ScreenPlay Pro HD is connected to your home network, all users on the network can load media files onto the drive or access the media collections stored on the ScreenPlay Pro HD to play files on your TV or individual computers.

This white paper offers suggestions on how to organize your media collections so everyone who uses your ScreenPlay Pro HD can find the media files they want to play. It also includes instructions on how to load media files to the ScreenPlay Pro HD across the network and how to access media files to play on your TV or computer.

## Organizing Your Multimedia Files

If you have a large collection of media files, you probably already know that it can be difficult to find a specific music file, video file, or photo unless you happen to remember the filename and can search for it. This problem is compounded when multiple users have access to add files to the media collection across a home network.

The solution is to use folders and subfolders to organize your media files in a way that is easiest and most sensible for you. The suggestions in this section should help you get started. Use them and your own creativity to develop an organization system that works best for you.

## ROOT Level

The main folder on the ScreenPlay Pro HD is called "ROOT". If you copy all of your media files to the ROOT level, it will quickly become difficult to find anything. Instead, create folders at the ROOT level for broad categories of media files. For example, you could create a folder for each type of media you place on the drive ("Photos" for image files, "Music" for music files, and "Videos" for video files).

Within the ROOT level folders, you can create additional subfolders to organize your files. For example, within the "Videos" folder, you could create a separate folder for each movie or video you want to store on the ScreenPlay Pro HD. You can also create subfolders to organize your media files into categories that will make it easy for you to find the files you want to play. For example, within the "Videos" folder, you could create subfolders for "Classics", "Family Favorites", "Action and Suspense", etc.

If you have a home network, you might find it helpful to create folders at ROOT level for each user on the network. Another possibility would be to create folders that combine users and media types. For example, on a network where Jason, Jen, and Russ are users, it might be helpful to create ROOT folders for "Jason's music", "Jason's videos", "Jen's music", "Jen's photos", etc. Each user can then organize their own subfolders to further organize their files. This approach works well when different users on the network have very different tastes and are less likely to want to find media someone else loaded to the ScreenPlay Pro HD.



## Using Subfolders

Whenever a folder accumulates more files than you can scan through quickly, consider dividing it into subfolders with smaller groups of files. For example, if you have a folder for "Video Classics" that contains 50 video files, think about how to organize them into smaller groups. Perhaps you could create subfolders for "Classic Kids Movies", "Classic Comedies", "Classic Action Adventure", and "Classic Dramas" within the "Video Classics" folder. Once you've created the subfolders you want to use, move the videos that fit in each category into the appropriate subfolder.

## Loading Media Files Using a Direct USB Connection

The fastest way to load a lot of multimedia files to the ScreenPlay Pro HD is to connect it directly to the computer where the files are stored. This also makes it very easy to create folders and subfolders to organize your media library. Follow the instructions below.

1. Turn off power to the ScreenPlay Pro HD.

**NOTE:** It is not necessary to disconnect the ScreenPlay Pro HD from the TV set if it's close enough to connect to your computer.

2. Use the included USB cable to connect the ScreenPlay Pro HD to a USB port on your computer.

**NOTE:** For best results always use the cable included with the drive. Long USB cables are not recommended as they might not provide adequate data or power transfer.

3. Make sure the ScreenPlay Pro HD is correctly connected to an uninterruptible power supply (UPS) or power outlet, then press the power button on the front of the ScreenPlay Pro HD to turn it on.
4. The ScreenPlay Pro HD will mount on your computer as an external hard drive.



### PC Users:

- a. Open My Computer or Windows Explorer and locate the drive letter assigned to the ScreenPlay Pro HD.
- b. Use the standard methods for your operating system to create folders on the ScreenPlay Pro HD and copy-and-paste or drag-and-drop your files.

### Mac Users:

Since NTFS is read-only on Mac OS X, you will need to reformat the drive to MS-DOS (FAT) before copying files to it. Refer to the next section on **Formatting the ScreenPlay Pro HD for Use on a Mac**.

**NOTE:** You can copy files to the ScreenPlay Pro HD on a Mac without changing the drive format if you use a network connection rather than a direct USB connection. See the section on **Loading Files to the ScreenPlay Pro HD Across the Network**.

5. Use the safe removal procedure for your operating system to unmount the drive, then disconnect the ScreenPlay Pro HD from your computer.



## Formatting the ScreenPlay Pro HD for Direct Use on a Mac

The default format on the ScreenPlay Pro HD is NTFS, which is read-only on Mac OS X. Before you can copy files to the ScreenPlay Pro HD using a direct USB connection on a Mac, you must use Disk Utility to format the drive to MS-DOS (FAT32). Follow the instructions below to change the format.

**NOTE:** The requirement to format the drive as a FAT32 volume applies only when connecting the ScreenPlay Pro HD directly to a Mac via USB. You can copy files to the ScreenPlay Pro HD on a Mac without changing the drive format if you use a network connection rather than a direct USB connection. When it is connected to a network, the Mac sees the ScreenPlay Pro HD as an SMB network share rather than as an NTFS-formatted external hard disk. Refer to the section on **Loading Files to the ScreenPlay Pro HD Across the Network** for additional information.

### Note the following limitations before changing the drive format:

- The ScreenPlay Pro HD must be formatted either NTFS or FAT32 in order to play back media files on a TV.
- A FAT32 volume may mount slower on a Mac OS system, and files may copy slower.
- The FAT32 file system has a maximum file size limit of 4GB.
- The FAT32 format can also be used with Windows 2000, XP, or Vista, but it is not as efficient as NTFS.

**CAUTION!** Formatting the drive will erase all existing data! If you have files on the drive you want to save, move them to another drive before reformatting.

### Formatting the ScreenPlay Pro HD using Mac OS X, version 10.4 and above

1. Make sure you have copied any needed files to another location.
2. Select **Applications** → **Utilities** → **Disk Utility**
3. In the left hand column, click on the drive icon for the ScreenPlay Pro HD. Make sure you click on the high level orange drive icon, not the second level volume icon.
4. Select the **Partition** tab.
5. Change Volume Scheme from **Current** to **1 Partition**.  
**NOTE:** Always format the ScreenPlay Pro HD as a single large volume. Only media files stored on the primary partition can be viewed or played on a TV.
6. Click the **Format** drop-down menu and select **MS-DOS File System** as the format type.
7. Click the **Options** button.
8. Select **Master Boot Record** as the partition type.
9. Click **OK**.
10. Click the **Partition** button.



## Loading Files to the ScreenPlay Pro HD Across a Network

If your ScreenPlay Pro HD is connected to a home network, you can access it from any computer on the network to create folders and copy/paste media files. This is an easy way to add files to your media library without having to disconnect the ScreenPlay Pro HD from the TV set.

**NOTE:** Copying files to the ScreenPlay Pro HD across a network is slower than copying files via a direct USB connection. If you have a large media library on your computer that you want to transfer to the ScreenPlay Pro HD, it is recommended that you use a direct USB connection rather than the network.

To connect to the ScreenPlay Pro HD as a network share, you can run the ScreenPlay Discovery utility to automatically map a drive letter, or you can manually map a drive letter. Follow the instructions below for the method and system you want to use.

### NOTES:

- The network computer must be on the same subnet or network segment as the ScreenPlay Pro HD.
- If you need to enter a username and password to login to a network volume, use the virtual keyboard on the ScreenPlay Pro HD TV display. The password can use any combination of numbers and letters (lower case or caps). It can also use periods. It cannot use extended punctuation characters (such as !, @, #, \$, %, &, etc.)

### Automatically mapping a drive letter with ScreenPlay Discovery

1. Insert the Solutions CD that shipped with the ScreenPlay Pro HD and install the ScreenPlay Discovery utility.
2. Run ScreenPlay Discovery to automatically connect to the ScreenPlay Pro HD:

#### PC Users:

- a. Click **Start** → **Iomega** → **ScreenPlay Pro HD**.
- b. Double click the icon for **ScreenPlay Discovery**.

#### Mac Users:

- a. Open the **Applications** folder.
- b. Double click the **Iomega** folder.
- c. Double click the **ScreenPlay Pro HD** folder.
- d. Double click the icon for **ScreenPlay Discovery**.

### Manually mapping a drive letter from a Windows PC

1. Make sure the ScreenPlay Pro HD is correctly connected to your TV and activated for playback.
2. At the main ScreenPlay Pro menu on the TV, select **Setup** and press the **ENTER** key.
3. Select **Network** and press the **ENTER** key. The display will show the IP address assigned to the ScreenPlay Pro HD on your network.
4. Using a PC connected to the Network, right click on the **Computer** (Vista) or **My Computer** (XP/2000) icon and select **Map Network Drive**.



5. Select the drive letter you want to use for the ScreenPlay Pro HD, then enter the IP address for the ScreenPlay Pro HD in the field next to **Folder** (for example, \\192.168.1.151).
6. You can now use My Computer or Windows Explorer to browse the ScreenPlay Pro HD and copy files from your network volumes onto the ScreenPlay Pro HD.

### Connecting to the ScreenPlay Pro HD over the Network from a Mac

1. Make sure the ScreenPlay Pro HD is correctly connected to your TV and activated for playback.
2. At the main ScreenPlay Pro menu on the TV, select **Setup** and press the **ENTER** key.
3. Select **Network** and press the **ENTER** key. The display will show the IP address assigned to the ScreenPlay Pro HD on your network.
4. On a Mac connected to the network, select **Connect to Server** from Finder's **Go** menu.
5. Under **Server Address**, enter "smb://" followed by the IP address for the ScreenPlay Pro HD (for example, **smb://192.168.1.151**).
6. Click **Connect**.
7. Select the shared folder to mount on your desktop.
8. You can now create folders and copy media files across the network to the ScreenPlay Pro HD.

### Accessing Media Files Across the Network

After setting up your media library on the ScreenPlay Pro HD, all users on your home network will have access to add files to the library or play files from the library on their individual computers. Simply run ScreenPlay Discovery to connect to the ScreenPlay Pro HD and mount it as a network volume on your computer. You can then navigate folders to select and play files, or add to the library by copying and pasting files from your computer.

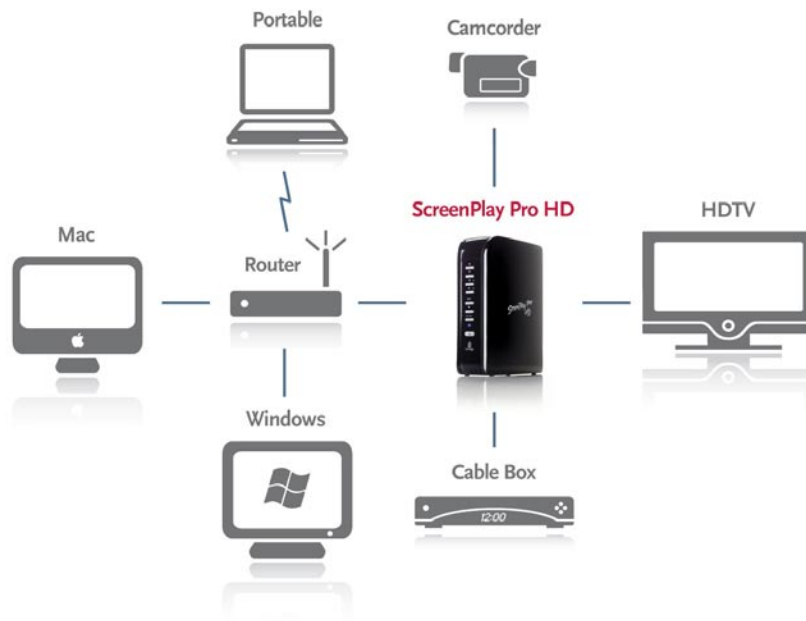

## Enjoying Your Media Library on the TV

With a well-organized media library stored on your ScreenPlay Pro HD, it's easy to enjoy your videos, music, and photos on your TV.

1. Make sure the ScreenPlay Pro HD is correctly connected to video and audio inputs on your TV.
2. Connect the ScreenPlay Pro HD to power.
3. Turn on your TV and change the input setting as needed to receive input from the ScreenPlay Pro HD. Refer to the manual that came with the TV if you are uncertain how to do this.
4. Point the remote control at the front of the ScreenPlay Pro HD and press the STANDBY button, or press the Standby/Power button on the front of the drive.
5. During activation, the blue LED will blink brightly for several seconds. When the blue LED glows steadily, the ScreenPlay Pro HD is ready to use for playback.

**NOTE:** Pressing the STANDBY button again will return the ScreenPlay Pro HD to Standby mode and turn off the blue LED. While in Standby mode, the ScreenPlay Pro HD will not respond to other navigation or command buttons.

6. When the main menu displays on the TV, you can select a source to browse for your media files.
  - **ScreenPlay Pro** – browse for files you've copied to your ScreenPlay Pro HD
  - **External USB** – browse folders and files located on an external USB device
  - **Network** – browse shared network volumes
7. After navigating to the file you want, just press the ENTER (Play/Pause) key on the remote control.



See the complete user's manual on the Solution CD or the Iomega web site for more information on using your ScreenPlay Pro HD!



Copyright © 2009 Iomega Corporation. All rights reserved. Iomega, ScreenPlay, and the stylized "i" logo are registered trademarks of Iomega Corporation in the United States and/or other countries. Microsoft and Windows are either registered trademarks or trademarks of Microsoft Corporation in the United States and/or other countries. Apple, Macintosh, and Mac are either registered trademarks or trademarks of Apple Inc. in the United States and/or other countries. Certain other product names, brand names, and company names may be trademarks or designations of their respective owners. 032709c